



LKAD019D-C



Class P SELV TYPE HL **CE** **RoHS**



Features

- Output:** Constant Current
- Range:** 350mA-700mA @ 20-42Vdc / 650mA-1200mA@10-22V (fixed & preset by factory)
- PFC design:** Built-in active PFC function
- Efficiency:** Up to 84%
- Protections:** Short circuit/ over load/ over temperature
- Heat dissipation:** Cooling by free air convection
- Waterproof Performance:** For dry, damp, wet locations
- Dimming function:** 0-10V dimming: 0-10V/1-10V/Potentiometer/10V PWM 4 in 1
- Dimming Range:** 0-100%
- Application:** Suitable for LED lighting and moving sign applications
- Warranty:** 5 years warranty



Specification

Model:		LKAD019DC120020C	LKAD019DC070042C	
Certificate		CUL,CE,Rosh,		
Output	DC Voltage	10-20V	20-42V	
	Voltage Tolerance	±0.5V		
	Voltage Regulation	±0.5%		
	Rated current	1200mA	700mA	
	Rated power	24W	29.4W	
	Load Regulation	±2%	±1%	
Input	Voltage Range	120-277VAC		
	Frequency Range	50/60hz		
	Power Factor(Typ.) @full load	0.98@120VAC	0.995@100VAC	
	THD(Typ.) @ full load	<15%@120VAC & 277VAC		
	Efficiency(Typ.) @ full load	≥84.78%@120VAC	≥84.7%@100VAC	
	AC Current (Max.)	0.58A		
	Inrush Current (Typ.)	15A, 50%, 1.4ms @120VAC	65A, 50%, 1.4ms @277VAC	
	Leakage current	<0.5mA		
Protection	Short Circuit	shut down o/p voltage, re-power on to recover after fault condition removed		
	Over Load	≤120% constant current limiting, auto-recovery after fault condition removed		
	Over temperature	100°C±10°C shut down o/p voltage, automatically recover after cooling		
Environment	Working TEMP.	-40~+60°C (see below derating curve)		
	Working Humidity	20 - 95%RH non-condensing		
	Storage TEM.,Humidity	-40 - +80°C,10 - 95% RH non-condensing		
	TEMP.coefficient	±0.03%/°C(0 - 50°C)		
	Vibration	10~500Hz, 5G 12min./1 cycle, period for 72min. each along X,Y,Z axes		
Safety & EMC	Safety standards	UL8750 , CAN/CSA-C22.2 No.250.13		
	Withstand voltage	I/P-O/P: 1.8KVAC I/P-FG: 1.8KVAC O/P-FG1.8KVAC		
	Isolation resistance	I/P-O/P: 100MΩ/ 500VDC/ 25°C/ 70% RH		
	EMC Emission	FCC 47 CFR Part 15 ,Subpart B		
Others	Net Weight			
	Dimension	88 * 37* 24mm(L*W*H)		
	Packing	Cartons		
Notes	1. All parameters NOT specially mentioned are measured at 120VAC input, rated load and 25°C of ambient temperature. 2. Tolerance: includes set up tolerance and load regulation.			



Electrical Characteristics

Model: LKAD019DC120020C							
Input voltage (Vac)	Input Current (mA)	Input Power (W)	Power Factor	Output Voltage (Vdc)	Output Current (MA)	Output Power (W)	Efficiency (%)
120	235.00	27.72	0.980	20.00	1175	23.50	84.78%
	177.10	21.08	0.987	15.00	1184	17.76	84.25%
	122.60	14.53	0.982	10.00	1193	11.93	82.11%
240	118.90	28.11	0.980	20.00	1209	24.18	86.02%
	93.48	21.75	0.964	15.00	1228	18.42	84.69%
	69.40	15.16	0.918	10.00	1240	12.40	81.79%
277	107.30	28.51	0.962	20.00	1220	24.40	85.58%
	85.95	22.11	0.931	15.00	1241	18.62	84.19%
	64.77	15.47	0.860	10.00	1261	12.61	81.51%

Model: LKAD019DC070042C							
Input voltage (Vac)	Input Current (mA)	Input Power (W)	Power Factor	Output Voltage (Vdc)	Output Current (MA)	Output Power (W)	Efficiency (%)
100	155.70	16.02	0.995	20.00	661	13.22	82.52%
	230.50	23.40	0.997	30.00	661	19.83	84.74%
	305.80	31.12	0.997	40.00	659	26.36	84.70%
240	71.15	16.04	0.938	20.00	663	13.26	82.67%
	99.87	23.15	0.964	30.00	661	19.83	85.66%
	128.90	30.19	0.973	40.00	660	26.40	87.45%
277	66.75	16.13	0.917	20.00	662	13.24	82.08%
	92.17	23.23	0.953	30.00	661	19.83	85.36%
	118.90	30.26	0.966	40.00	659	26.36	87.11%

Efficiency Curve (efficiency vs ouput watt)

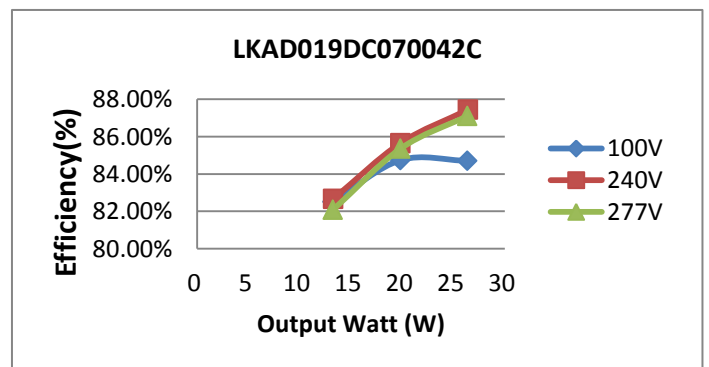
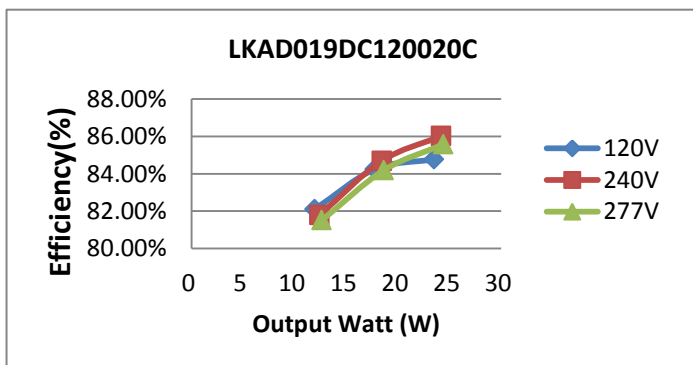



Power Factor Curve

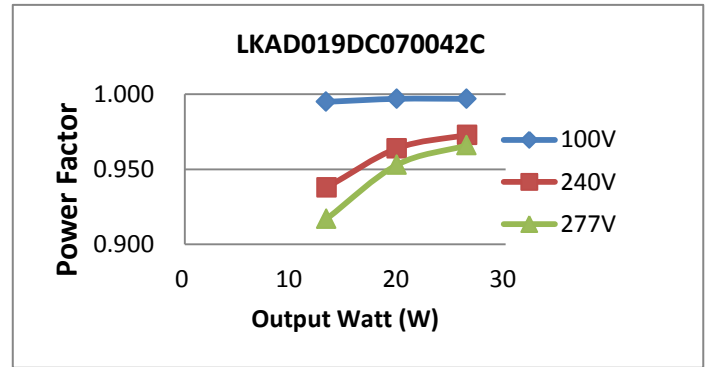
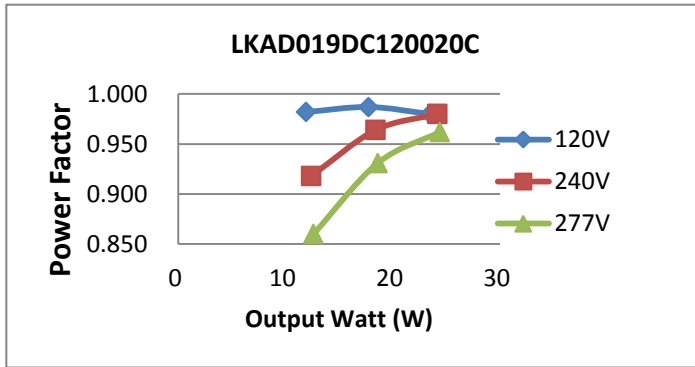

0-10V Dimming Curve

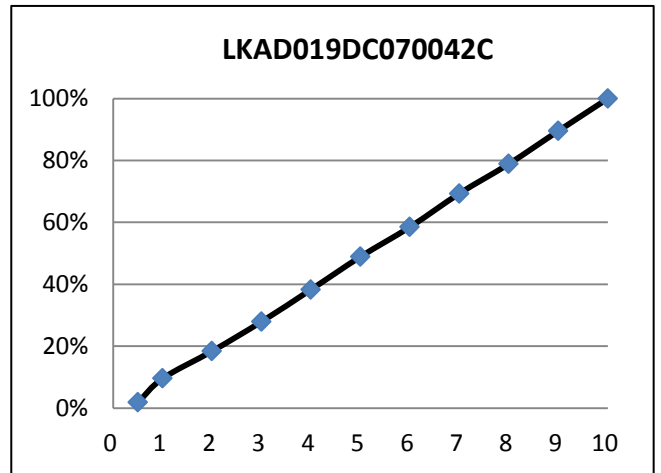
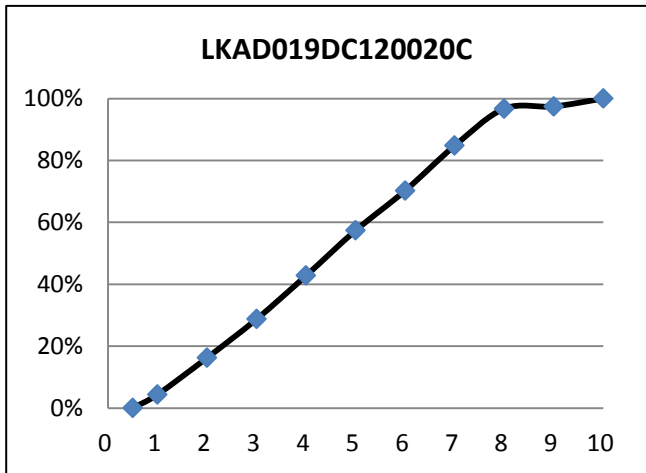

Derating Curve (output load vs TEMP.)

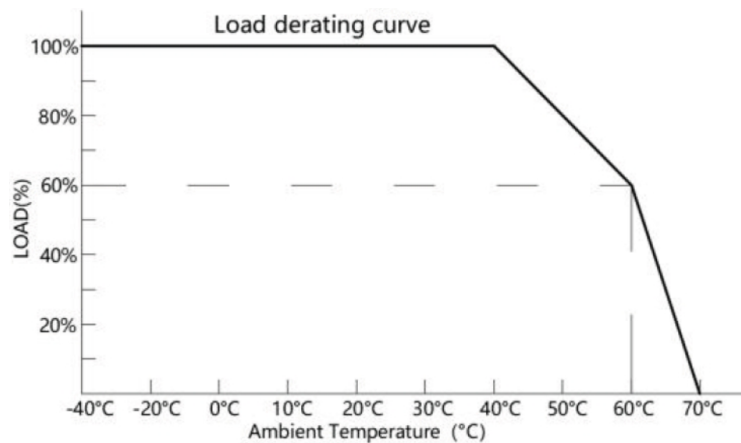



Installation Dimension

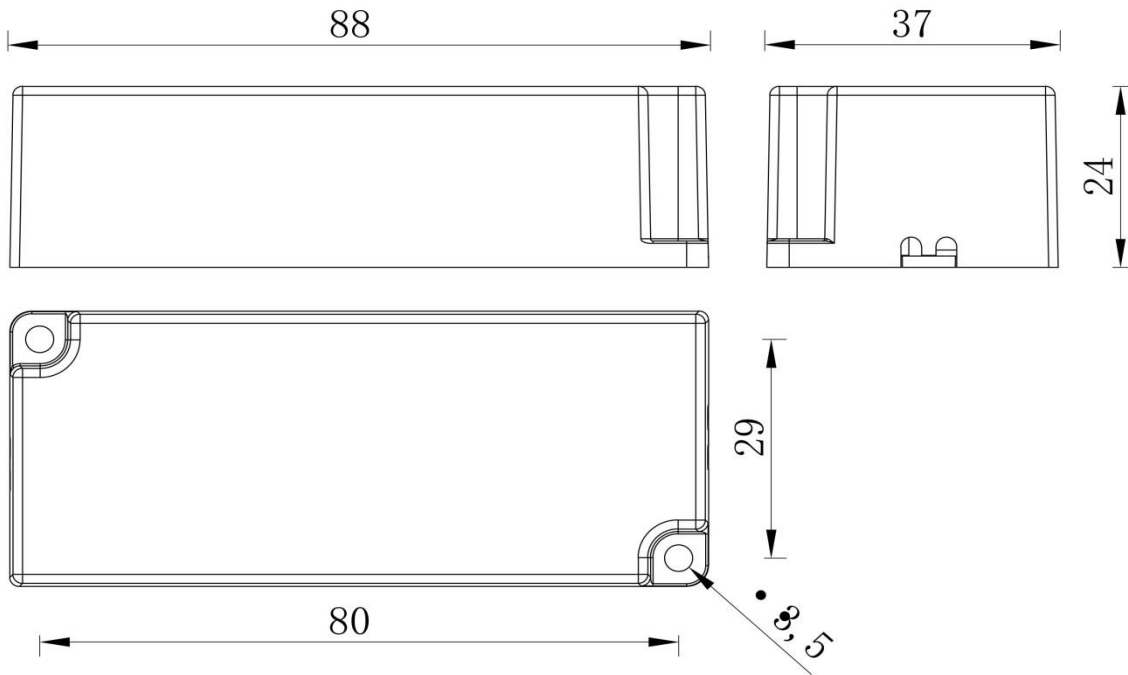

Wiring Diagram

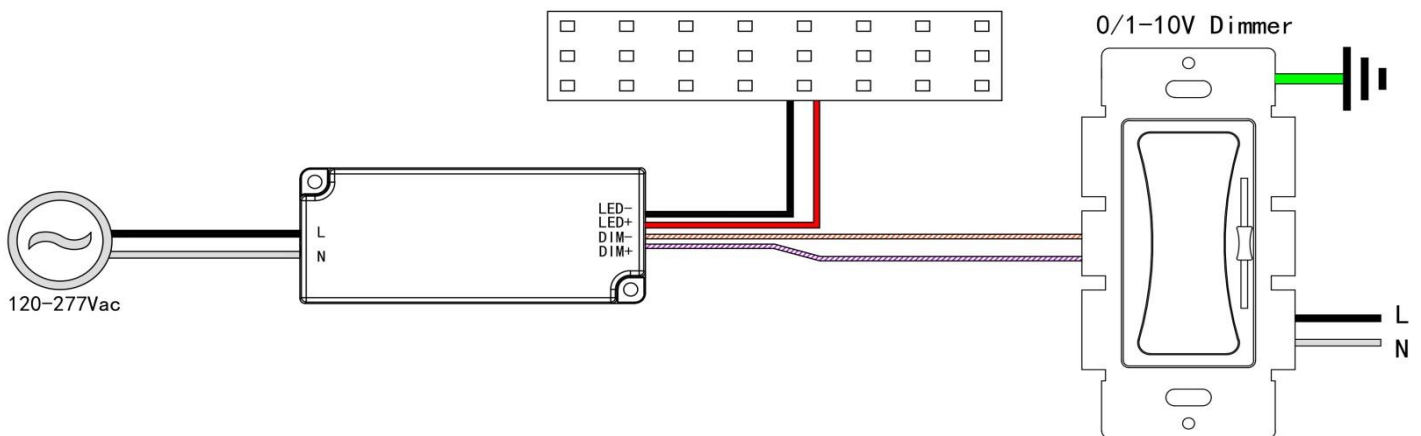

1. Input cable 2*18AWG, Black cable to L, and White cable to N of Mains AC.
2. Output cable 2*18AWG, Red cable (+) to LED Positive side (+) , Black cable (-) to LED Negative side (-).
3. Dimming cable 2*22AWG, Purple cable DIM (+) to 0/1-10V dimmer signal(+), Pink cable DIM (-) to 0/1-10V dimmer signal (-).
4. Please make sure your connect these correctly otherwise your product will not function correctly and could be damaged



Dimming Operation

Working well with most EU and US brands of 0/1-10V dimmers, 10V PWM dimmers or dimming system as well as potentiometer dimming system.

Notices

1. This driver should be installed by qualified and professional person.
2. Please make sure the driver is installed with adequate ventilation around it to allow for heat dissipation.
3. Ensure that wiring is correct before test in order to avoid light and power supply damage.
4. If driver Cannot work normally, don't maintain privately.

If still have any questions, please contact us directly